

für Rollenschienen // KUGELROLLEN

for roller tracks // BALLROLLER<

pour rails à rouleaux // ROULEAU À BILLES <



Anwendungsbeispiel

> application example
> exemple d'application



freie Eckumsetzung von Behältern und Kartons

> free corner transfer of containers and boxes
> transfert d'angle gratuit des conteneurs et boîtes

individuell konfigurierbare Kugelfelder & Kugelrollenschienen

> individually configurable ball fields & ball roller tracks
> terrains de balle et pistes de roulement à billes configurables individuellement

kompatibel mit allen Rollenschienenverbindern Typ 40

> compatible with all connectors for roller tracks type 40
> compatible avec tous les connecteurs pour rails à rouleaux type 40  6.01

Rollenschienenkörper

> roller track body
> corps de rail à rouleaux

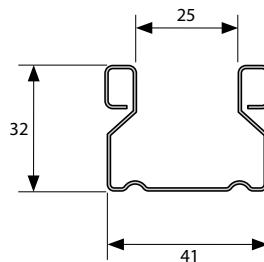
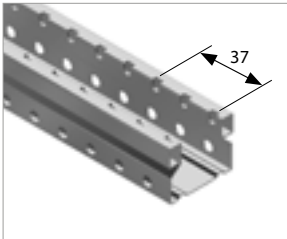



 **08.00958.00**
Stahl, verzinkt
> galvanised steel
> acier zingué

 2 m
20 m

Kugelrollenleiste

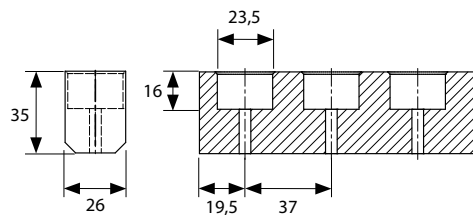
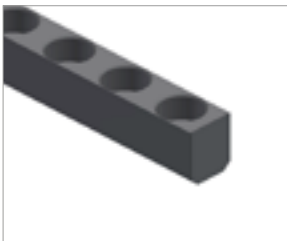
> ball roller bar
> barre à billes





 **08.00956.00** 
Kunststoff PE 1000
> plastic PE 1000
> plastique PE 1000

 2 m
20 m

Kugelrolle

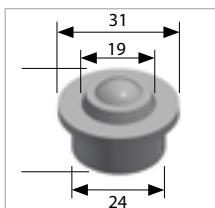
> ball roller
> rouleau à billes



 **08.00957.00**
Stahlkugel in Blechkäfig
> steel ball in a metal cage
> bille d'acier dans une cage métallique

Abdeckkappe

> cover cap
> couvercle

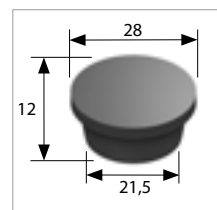

 **08.00959.00**
Polyethylen PE-LD
> polyethylene PE-LD
> polyéthylène PE-LD